

PART NUMBER

SMC (18-24)

PARTS LIST		
ITEM	QTY	Description
1	1	SMC Leg (18" - 24")
2	2	3/8 X 3 FLANGE BOLT SERRATED
3	2	3/8 USS FLAT WASHER
4	2	3/8 HEX NYLON INS NUT

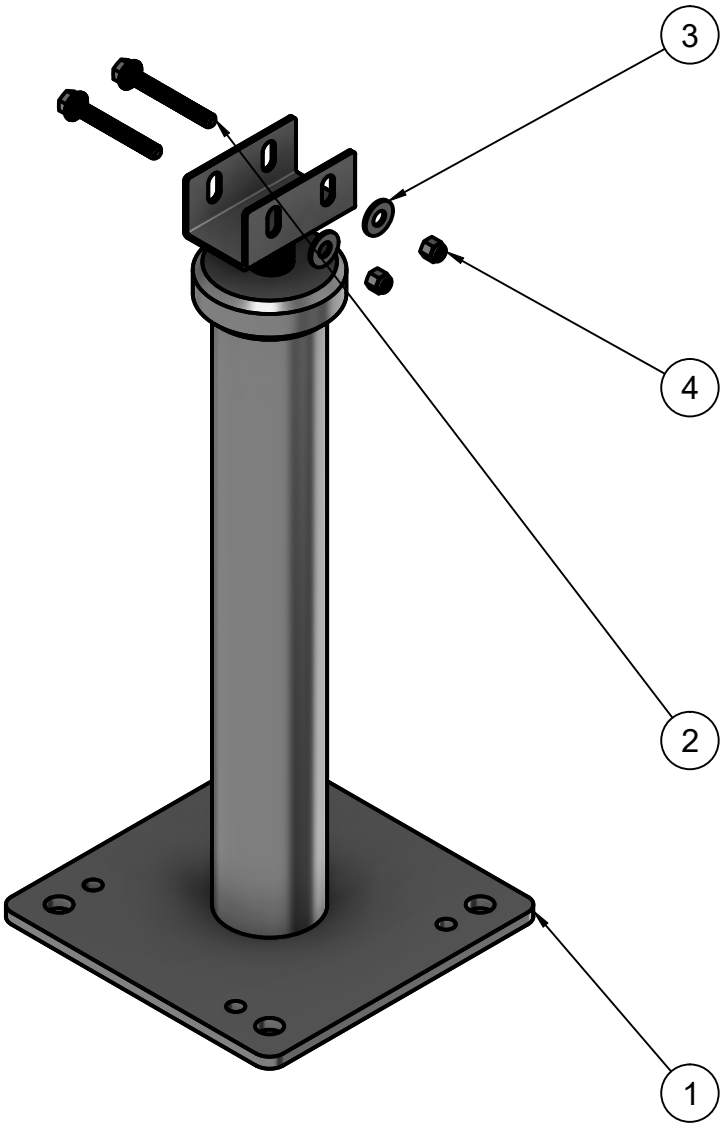

SHIPPING INFO			
BOXED DIMS	11 x 20 x 25	PALLET QTY	16
BOXED LBS	30	PALLET DIMS	48 x 44 x 32
INSTALL VIDEO	<a href="#">HERE</a>	PALLET LBS	512



This sheet is meant only to highlight EcoFoot's products and specifications. Information is subject to change without notice. EcoFoot takes responsibility for furnishing quality materials, which meet published product specification. As neither EcoFoot itself, nor its representatives practice architecture, EcoFoot offers no opinion on, and expressly disclaims any responsibility for the soundness of any structure on which its products may be applied. If questions arise as to the soundness of structure, or its ability to support planned installation properly, the Owner should obtain opinions of competent structural engineers before processing. EcoFoot accepts no liability for any structural failure or for resultant damages, and no EcoFoot Representative is authorized to vary this disclaimer.

D01) GENERAL

D01-1 GENERAL INFORMATION

1. THE INFORMATION PRESENTED ON THESE DRAWINGS HAS BEEN DESIGNED AND ANALYZED IN ACCORDANCE WITH THE 2012 ONTARIO BUILDING CODE AS AMENDED JAN 01, 2020 & 2015 NATIONAL BUILDING CODE OF CANADA. CONSTRUCTION IS TO BE PERFORMED IN ACCORDANCE WITH THIS AND ALL OTHER APPLICABLE CODES.
- 1.1 STEEL STRUCTURE DESIGNED IN ACCORDANCE WITH CSA-S16-14
2. PROPRIETARY SYSTEMS ARE TO BE INSTALLED IN STRICT ACCORDANCE WITH MANUFACTURER'S RECOMMENDATIONS.
3. DO NOT SCALE THESE DRAWINGS.
4. VERIFY ALL DIMENSIONS AND EXISTING CONDITIONS ON SITE PRIOR TO FABRICATION.

D01-2 DESIGN LOADS

SEISMIC POST CAN RESIST A MAXIMUM OF THE FOLLOWING LOADS APPLIED AT THE TOP CONNECTION POINT:

Vf (ANY DIRECTION) = 3.0kN

THE REVIEW OF THE BASE BUILDING STRUCTURE, FOR THE ADDITIONAL LOADS IMPOSED BY THE RTU, IS THE SOLE RESPONSIBILITY OF THE BASE BUILDING ENGINEER OF RECORD.

D02) STEEL

D02-1 STRUCTURAL STEEL:

STRUCTURAL STEEL SHALL COMPLY WITH CSA S16 UNLESS OTHERWISE NOTED.

ITEM	APPLICABLE SPECIFICATION (UNLESS OTHERWISE NOTED)
HSS (TUBE) SECTIONS	ASTM A500 FY=345MPA
THREADED ROD	GRADE B7 (MIN FY=720MPA)
PLATES	CSA G40.21-300W
1. FIELD AND SHOP CONNECTIONS SHALL BE WELDED.	
1. WELDING SHALL CONFORM TO LATEST CSA SPECIFICATION W59 AND BE UNDERTAKEN BY A FABRICATOR APPROVED BY THE CANADIAN WELDING BUREAU TO THE REQUIREMENTS OF CSA SPECIFICATION W47.1.	
2. ALL EXPOSED WELDS SHALL BE CONTINUOUS AND BE GROUND SMOOTH.	
3. STRUCTURAL STEEL MEMBERS SHALL NOT BE SPLICED UNLESS APPROVED BY THE STRUCTURAL ENGINEER IN WRITING.	
4. WHERE STRUCTURAL STEEL MEMBERS SPECIFIED ON THE STRUCTURAL DRAWINGS ARE UNAVAILABLE TO THE CONTRACTOR, THE STRUCTURAL STEEL CONTRACTOR SHALL PROVIDE MEMBERS HAVING ALL SECTION PROPERTIES EQUAL TO OR BETTER THAN THAT OF THE SPECIFIED MEMBERS AT NO ADDITIONAL COST. CONTACT ENGINEER FOR ACCEPTANCE OF ANY AND ALL SUBSTITUTIONS.	
5. ALL STEEL COMPONENTS IN ASSEMBLY TO BE POWDER COATED.	

The Contractor shall check and verify all dimensions on site. This drawing is not to be used for construction unless stamped and signed by the Engineer. Do not scale drawings. Copyright reserved. This drawing is the exclusive property of Cleland Jardine Engineering Ltd.



3	10/26/2021	ISSUED FOR CLIENT REVIEW	KT
2	05/13/2021	ISSUED FOR CLIENT REVIEW	KT
1	04/09/2021	ISSUED FOR CLIENT REVIEW	KT



PROJECT  
ECOFOOT SEISMIC POST

DRAWING  
SECTIONS AND DETAILS  
FOR CONCRETE  
STRUCTURES

DRAWN:	K.T
DESIGNED:	G.D
DATE:	04/09/2021
SCALE:	AS NOTED
PROJECT No:	20-2404

DRAWING No.

SK1

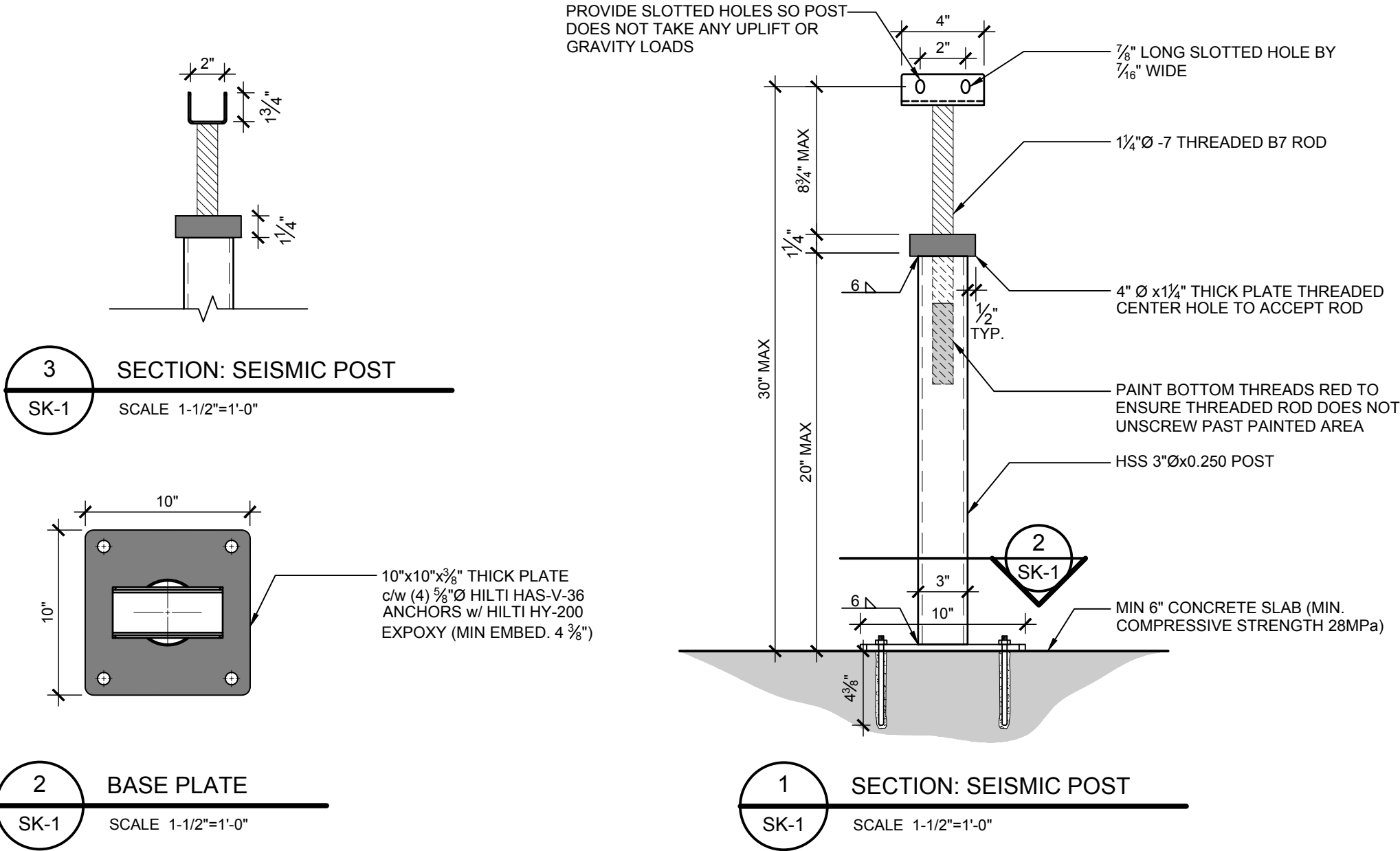

D01) GENERAL

D01-1 GENERAL INFORMATION

1. THE INFORMATION PRESENTED ON THESE DRAWINGS HAS BEEN DESIGNED AND ANALYZED IN ACCORDANCE WITH THE 2012 ONTARIO BUILDING CODE AS AMENDED JAN 01, 2020 & 2015 NATIONAL BUILDING CODE OF CANADA. CONSTRUCTION IS TO BE PERFORMED IN ACCORDANCE WITH THIS AND ALL OTHER APPLICABLE CODES.
- 1.1 STEEL STRUCTURE DESIGNED IN ACCORDANCE WITH CSA-S16-14
2. PROPRIETARY SYSTEMS ARE TO BE INSTALLED IN STRICT ACCORDANCE WITH MANUFACTURER'S RECOMMENDATIONS.
3. DO NOT SCALE THESE DRAWINGS.
4. VERIFY ALL DIMENSIONS AND EXISTING CONDITIONS ON SITE PRIOR TO FABRICATION.

D01-2 DESIGN LOADS

SEISMIC POST CAN RESIST A MAXIMUM OF THE FOLLOWING LOADS APPLIED AT THE TOP CONNECTION POINT:

Vf (ANY DIRECTION) = 3.0kN

THE REVIEW OF THE BASE BUILDING STRUCTURE, FOR THE ADDITIONAL LOADS IMPOSED BY THE RTU, IS THE SOLE RESPONSIBILITY OF THE BASE BUILDING ENGINEER OF RECORD.

D02) STEEL

D02-1 STRUCTURAL STEEL:

STRUCTURAL STEEL SHALL COMPLY WITH CSA S16 UNLESS OTHERWISE NOTED.

ITEM	APPLICABLE SPECIFICATION (UNLESS OTHERWISE NOTED)
HSS (TUBE) SECTIONS	ASTM A500 FY=345MPA
THREADED ROD	GRADE B7 (MIN FY=720MPA)
PLATES	CSA G40.21-300W
1. FIELD AND SHOP CONNECTIONS SHALL BE WELDED.	
1. WELDING SHALL CONFORM TO LATEST CSA SPECIFICATION W59 AND BE UNDERTAKEN BY A FABRICATOR APPROVED BY THE CANADIAN WELDING BUREAU TO THE REQUIREMENTS OF CSA SPECIFICATION W47.1.	
2. ALL EXPOSED WELDS SHALL BE CONTINUOUS AND BE GROUND SMOOTH.	
3. STRUCTURAL STEEL MEMBERS SHALL NOT BE SPLICED UNLESS APPROVED BY THE STRUCTURAL ENGINEER IN WRITING.	
4. WHERE STRUCTURAL STEEL MEMBERS SPECIFIED ON THE STRUCTURAL DRAWINGS ARE UNAVAILABLE TO THE CONTRACTOR, THE STRUCTURAL STEEL CONTRACTOR SHALL PROVIDE MEMBERS HAVING ALL SECTION PROPERTIES EQUAL TO OR BETTER THAN THAT OF THE SPECIFIED MEMBERS AT NO ADDITIONAL COST. CONTACT ENGINEER FOR ACCEPTANCE OF ANY AND ALL SUBSTITUTIONS.	
5. ALL STEEL COMPONENTS IN ASSEMBLY TO BE POWDER COATED.	

The Contractor shall check and verify all dimensions on site.  
This drawing is not to be used for construction unless stamped and signed by the Engineer.  
Do not scale drawings. Copyright reserved. This drawing is the exclusive property of Cleland Jardine Engineering Ltd.



3	10/26/2021	ISSUED FOR CLIENT REVIEW	KT
2	05/13/2021	ISSUED FOR CLIENT REVIEW	KT
1	04/09/2021	ISSUED FOR CLIENT REVIEW	KT



PROJECT  
ECOFoot SEISMIC POST  
FOR STEEL STRUCTURES

DRAWING  
SECTIONS AND DETAILS

DRAWN:	K.T
DESIGNED:	G.D
DATE:	04/09/2021
SCALE:	AS NOTED
PROJECT No:	20-2404

DRAWING No.

SK2

