

EB-40s

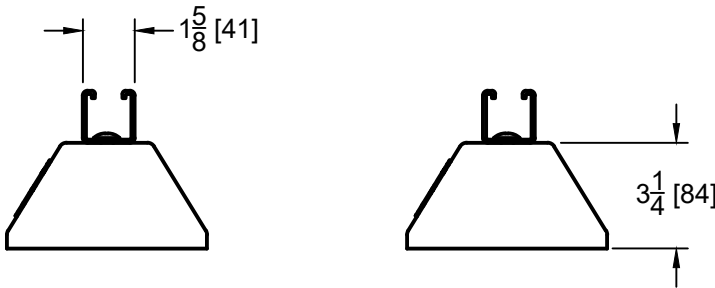

PARTS LIST	
QTY	DESCRIPTION
8	EB-9 BASE BLOCK
2	40" STRUT

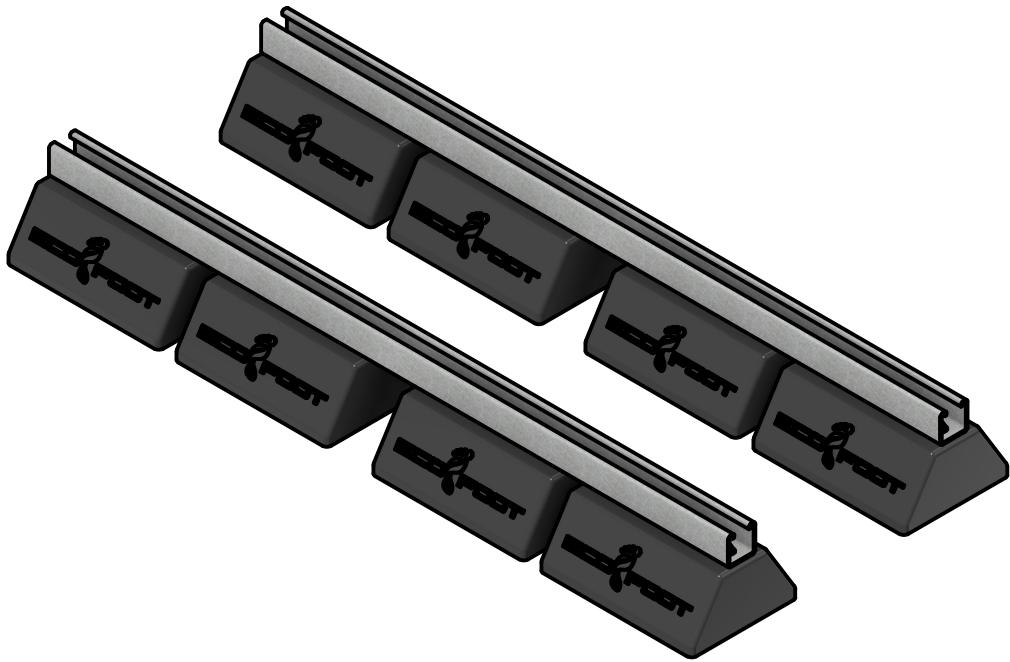
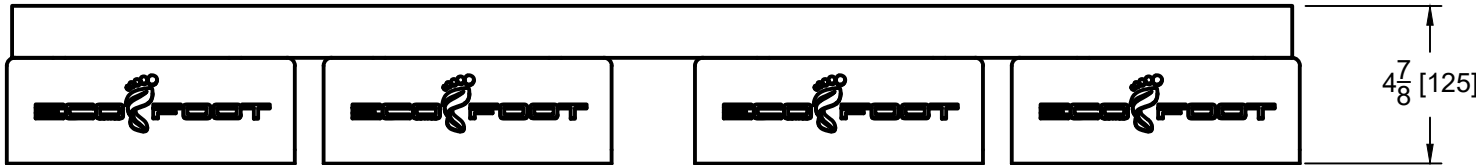
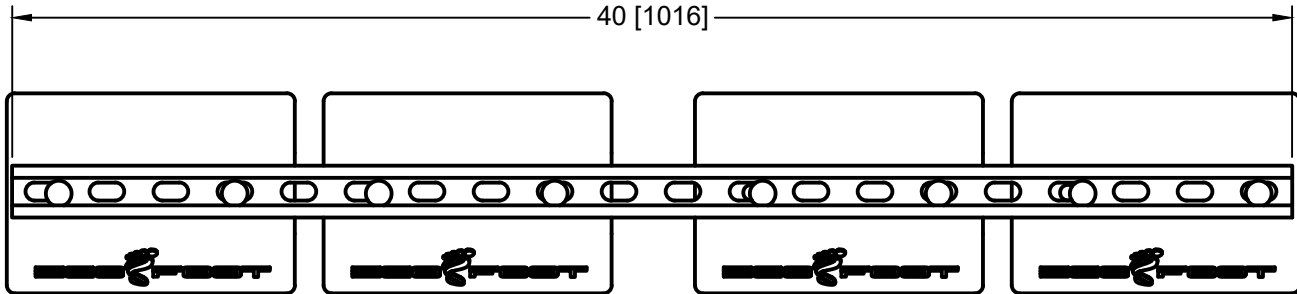
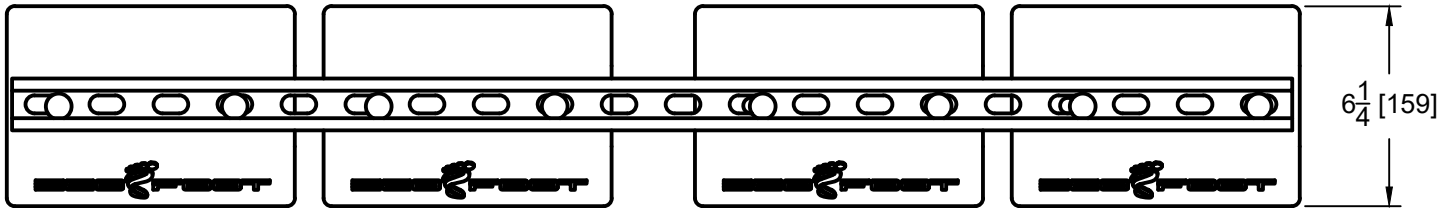

RECOMMEND MAX LOAD : 400 LBS

SHIPPING INFO			
BOXED DIMS:	SHIPS LOOSE	PALLET QTY:	50
BOXED LBS:	30.8	PALLET DIMS:	48 x 44 x 40
INSTALL	VIDEO	PALLET LBS:	1.540

This sheet is intended to highlight EcoFoot's products and specifications. Information is subject to change without notice. EcoFoot takes responsibility for providing quality materials that meet published product specification. However, neither EcoFoot nor its representatives practice architecture or engineering. Therefore, EcoFoot offers no opinion on, and expressly disclaims any responsibility for the soundness of any building or structure on which its products may be applied. If questions arise regarding the soundness of structure, building envelope, or its ability to support planned installation, the Owner should consult relevant professionals before proceeding. EcoFoot accepts no liability for any structural or building envelope failure or resultant damages, and no EcoFoot representative is authorized to vary this disclaimer.